





Studio dell'Architetto MATTEO PICCHIO
Via del Vecchio Politecnico, 9 - 20121 - Milano (IT)
Phone +39 02781194 - Fax +39 02781105
info@matteopicchio.com - www.matteopicchio.com

BACKGROUND - According to this designer, the relationship with the client must be based on the essential principles of reciprocal esteem and trust, almost friendship, whether one is dealing with the design of a tailor-made boat or simply a refitting. *"The ability to trace the outlines of a dream with extreme precision is without doubt the result of a deep understanding of the client, his hobbies, needs and expectations."* This is a modus operandi that Picchio has consolidated with the passage of time, ever since, at 19 years of age, he had his first taste of this field, restoring a 14-metre Ketch Oceanico of which he is still the owner and that he uses as a second home when in Genoa for work. This experience of restoration, or better, of restyling the "Raireva", continues to inspire the Designer, who talks about it with justified pride. In fact, proposing the revisiting of classics is one of the activities of Picchio's studio, apart from, obviously, the design of new boats. The strength of the studio is without doubt to be found in the skill of its working partners, but also in Picchio's training, a training that imposes on him an architectural, and thus more complex, profound and complete approach. This is coupled with the emotional element that he brings to each project. Work of a superior quality is guaranteed, work that one cannot simply reduce to the concept "Ship Design".

STYLE - Refined chastesness and strong recall to the nautical tradition are the elements which as well as the neverending research for state-of-the-art technological solutions, set Matteo Picchio apart. The ability to realize ships, even large ones, which match both performance and comfort is the trademark of the Studio. Picchio's background, as mentioned, grants itself to care every aspect of the building process, from the draft to the real construction. This is a remarkable advantage for those who wants to have only one direct interlocutor who does not only propose solutions suggested by his knowledge but who's also representing the link between each phase of the building process.



PROJECTS - An ambitious project. A Sloop (photo right page) that with its length of 48 metres and its notable mast (56.63 metres) is set to become a part of the set of the world's grandest sailboats. Beginning with a concept shared with its future owner, Picchio's studio has co-ordinated every aspect of the project, from the interior design to the day-to-day running of the construction process. The imposing megasailer will answer to the owner's need of a yacht that can go on major cruises in both cold and warm seas with the maximum of comfort. To achieve this, even the choice of materials was the result of an in-depth study on the part of Picchio: *"The hull, the deck and the structure of the superstructure will therefore be made with a light alloy...the mast, the boom and the bowsprit with carbon fibre"*.

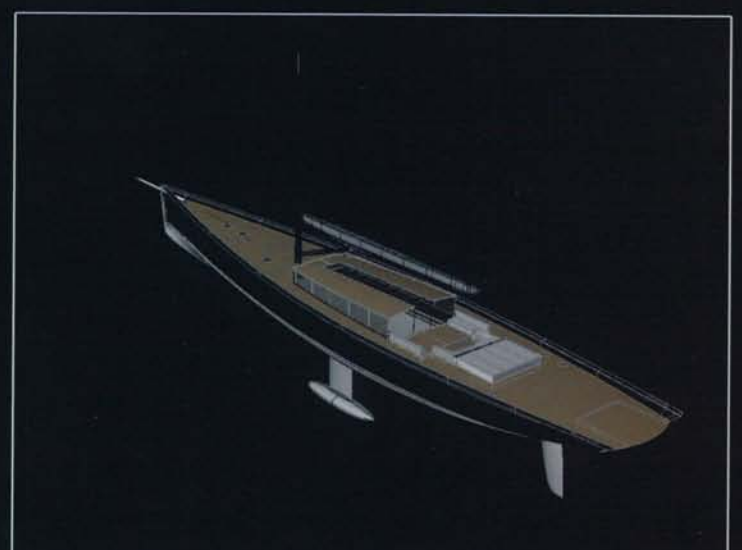
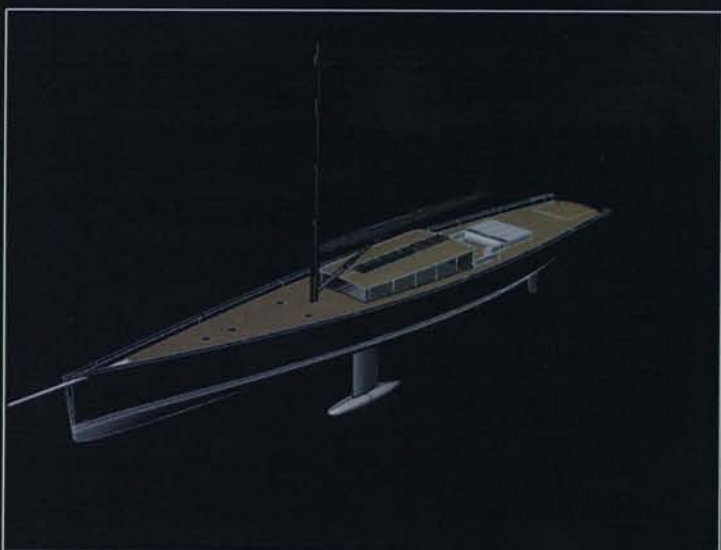
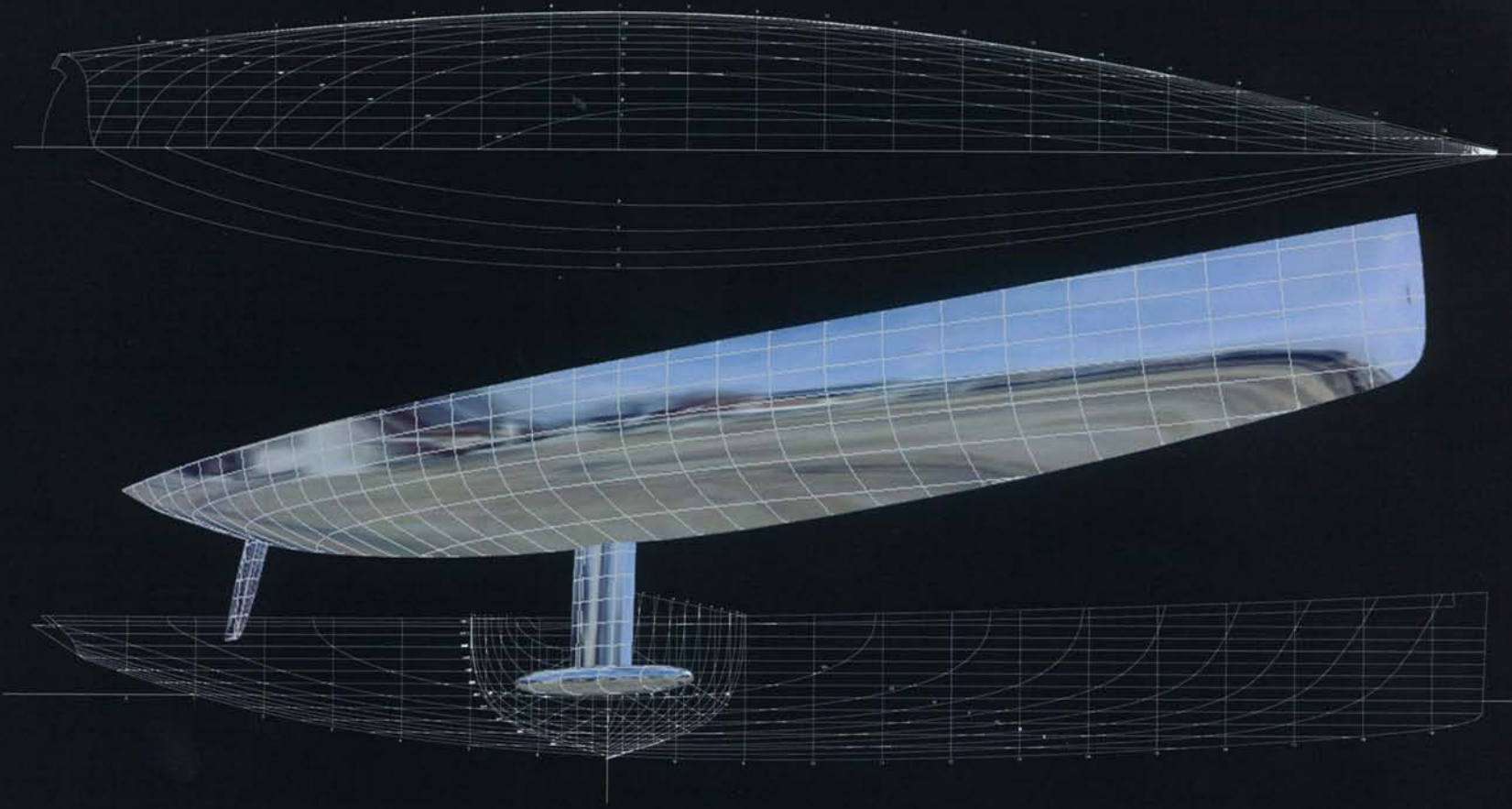

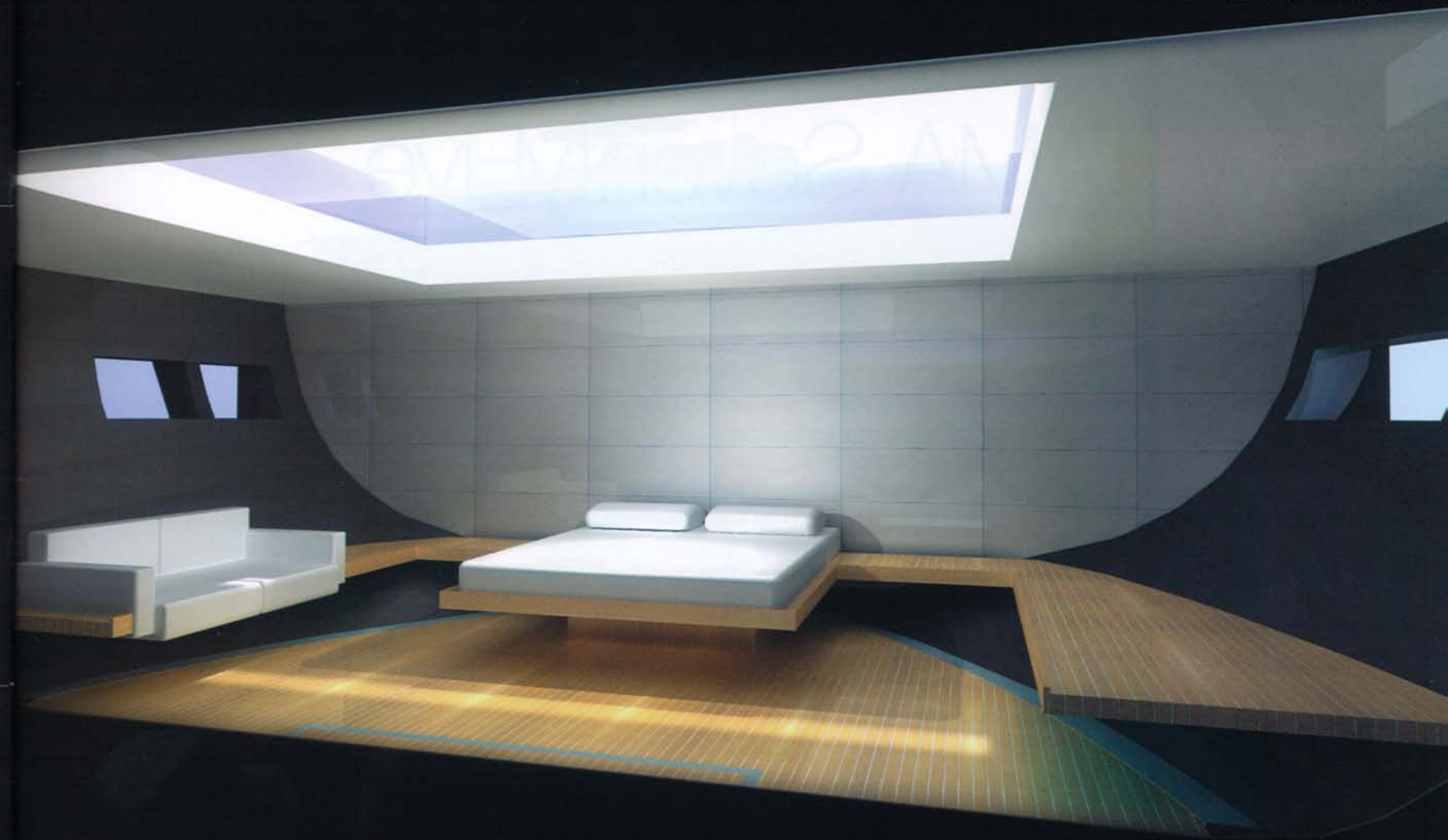

In order to guarantee navigation also in shallow water, a vertically-sliding keel has been designed, which will drastically reduce the draught (from 6.46 metres to 4.06 metres). The exterior design is particularly original, thanks to the flash deck occupied only by a low wheelhouse with crystal side mastre. The bridge area, above the slope of the stern, is characterised by an oleodynamic system that allows the bridge area to descend to sea level, creating what is, effectively, a little beach. The inside is characterised by the use of natural light and the wide spaces of the planned 5 cabins, one of which, the owner's (at the stern) is a good 3 metres high. Particular attention is paid to privacy: "It is fundamental that the crew fully enjoy their free time inside a well-defined space...therefore the crew area has independent access located at the bow, made up of 3 double cabins as well as a dinette and self-sufficient kitchen." The project foresees more spaces, including a room that will function as a wine-cellar and an area dedicated to relaxation, with a Turkish bath and a large jacuzzi; all this is proof of a boat that has been designed for long voyages. The launch of the Sloop designed by the Architect Picchio is planned for the spring of 2010. We will be following the developments in the project with great interest in the pages of Absolute Yachting.